

1  
72

TYPICAL CROSS SECTION

NO SCALE

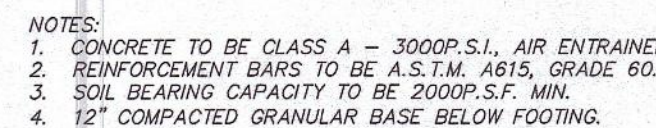
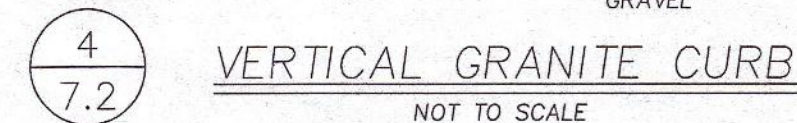
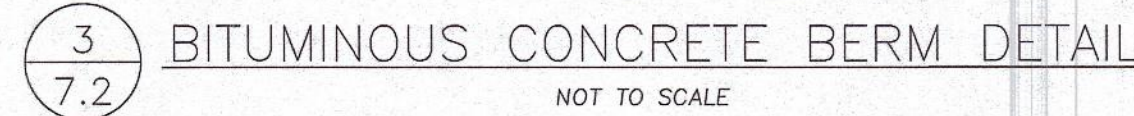
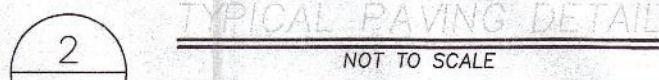

\*\*SPACING OF "O" REBARS VARIES - SEE SECTION.  
 \*FACE OF WALL TO BE BATTERED 1" OVER ENTIRE HEIGHT WHERE "A" IS GREATER THAN 5'-6" AND LESS THAN OR EQUAL TO 9'-0".  
 \*FACE OF WALL TO BE BATTERED 2" OVER ENTIRE HEIGHT WHERE "A" IS GREATER THAN 9'-0".  
 CONT. = CONTINUOUS GA = GAUGE HORIZ. = HORIZONTAL LENG. = LENGTH MAX. = MAXIMUM O.C. = ON CENTER QUAN. = QUANTITY SPAC. = SPACING VERT. = VERTICAL

5  
7.2

CONCRETE RETAINING WALL DETAIL

NOT TO SCALE

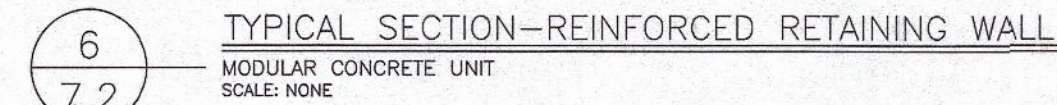

- IF CONDITIONS ARE DIFFERENT THAN THOSE STATED  
IN THESE DRAWINGS AND SPECIFICATIONS, THE CONTRACTOR  
MUST CONTACT ENGINEER PRIOR TO PROCEEDING WITH  
THE CONSTRUCTION OF THE WALL.



1. SEE PLANS FOR CURB TYPE.
2. CURBS AND WALKS ALONG ACCESSIBLE ROUTES SHALL MEET OR EXCEED THE APPLICABLE REGULATIONS OF THE AMERICANS WITH DISABILITIES ACT.
3. THE MAXIMUM ALLOWABLE SIDEWALK AND CURB RAMP CROSS SLOPE SHALL BE 2% (1 IN. 48 IN.).
4. THE MAXIMUM ALLOWABLE SLOPE OF ACCESSIBLE ROUTES, EXCLUDING RAMP SHALL BE 5%.
5. THE MAXIMUM ALLOWABLE SLOPE OF ACCESSIBLE ROUTE CURB RAMP SHALL BE 8%.
6. MAINTAIN A MINIMUM OF 3 FEET CLEAR AT ANY PERMANENT OBSTACLE ALONG ACCESSIBLE ROUTES (E.G. TREE WELLS, HYDRANTS, UTILITY POLES, ETC.).
7. GRADE BASE OF RAMP TO PREVENT POtholes.
8. SIDEWALKS AND CURBS ALONG SIDEWALK SECTION WHERE ACCESSIBLE ROUTES ARE LESS THAN 5' IN WIDTH (EXCLUDING CROSSING) SHALL BE 5' WIDE. CROSSING PASSING AREA SHALL BE PROVIDED AT INTERVALS NO LONGER THAN 200 FEET.
9. ALL CURBING AT RAMPS SHALL BE VERTICAL CURBING SET FLUSH WITH SIDEWALK.
10. ALL RAMPS SHALL BE CEMENT CONCRETE WITH ROUGHENED NON-SKID SURFACE.

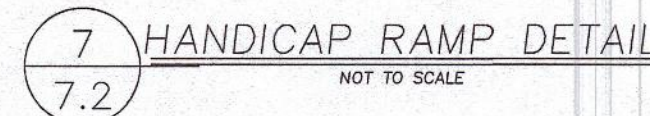

P.E.

COMMONWEALTH OF MASSACHUSETTS

MICHAEL  
DEAN  
CIVIL  
No. 46255

REGISTERED  
PROFESSIONAL ENGINEER

5202

REVISIONS		
REV.	DATE	DESCRIPTION
1	1/8/24	REVISED PLANS.
2	3/25/24	REVISED PLANS
3	5/19/24	REVISED PLANS.

PLAN NO.

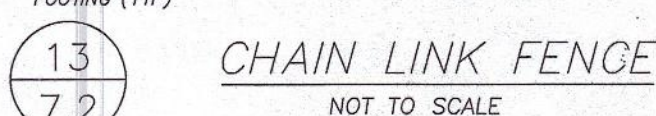

- NOTES:
1. TOP TENSION WIRE SHALL BE 7 GAUGE ATTACHED WITH 12.5 GAUGE HOG RINGS, 12" O.C.
  2. TOP RAIL WIRE TIES SHALL BE SPACED AT 24" MAX.
  3. FENCE FABRIC TO BE LOCATED ON OUTSIDE OF FENCE POSTS.
  4. BOTTOM OF FENCE FABRIC TO BE SECURED TO RETAINING WALL.

